

- Kitchen model**  
Xila
- Carcass**  
melamine graphite grey oak
- Doors & Panels**  
base units: shades marble carrara  
side panels: granito nero zimbabwe  
wall units: DeCastelli striped inox 7022  
side panels: lasermat black ingo
- Handle**  
handrail alu black
- Plinth**  
h.80 black
- Countertop & Backsplash**  
n.1 top in nero zimbabwe W.2422 Dp.725 (TMRALA5)  
n.1 top in nero zimbabwe W.1222 Dp.725 (TMRALA5)  
n.1 backsplash in nero zimbabwe W.2422 Dp.567 (SPCPNN01)  
n.1 backsplash in nero zimbabwe W.1222 Dp.567 (SPCPNN01)
- Sink & Tapware**  
n.1 new bowl in nero zimbabwe 1004x404  
n.1 mixer Pipe PVD(REFP09 + ALER01N + ANEF01N + ALQQ008)
- Complimentary Items & Accessories**  
accessories Easychef: see the drawing  
dustbin kit for undersink base unit W.1200 (ABT3030)  
kit led light for undersink base unit W.1200 (2\*GMDD15 + AVPE007)
- Electrical Appliances BY CLIENT**  
n.1 dishwasher Miele mod. G 7660 SCVi  
n.1 flush-mounted induction hob unit Miele mod. KM 7684 FL  
n.1 flush-mounted hood Miele mod. DAD 4841

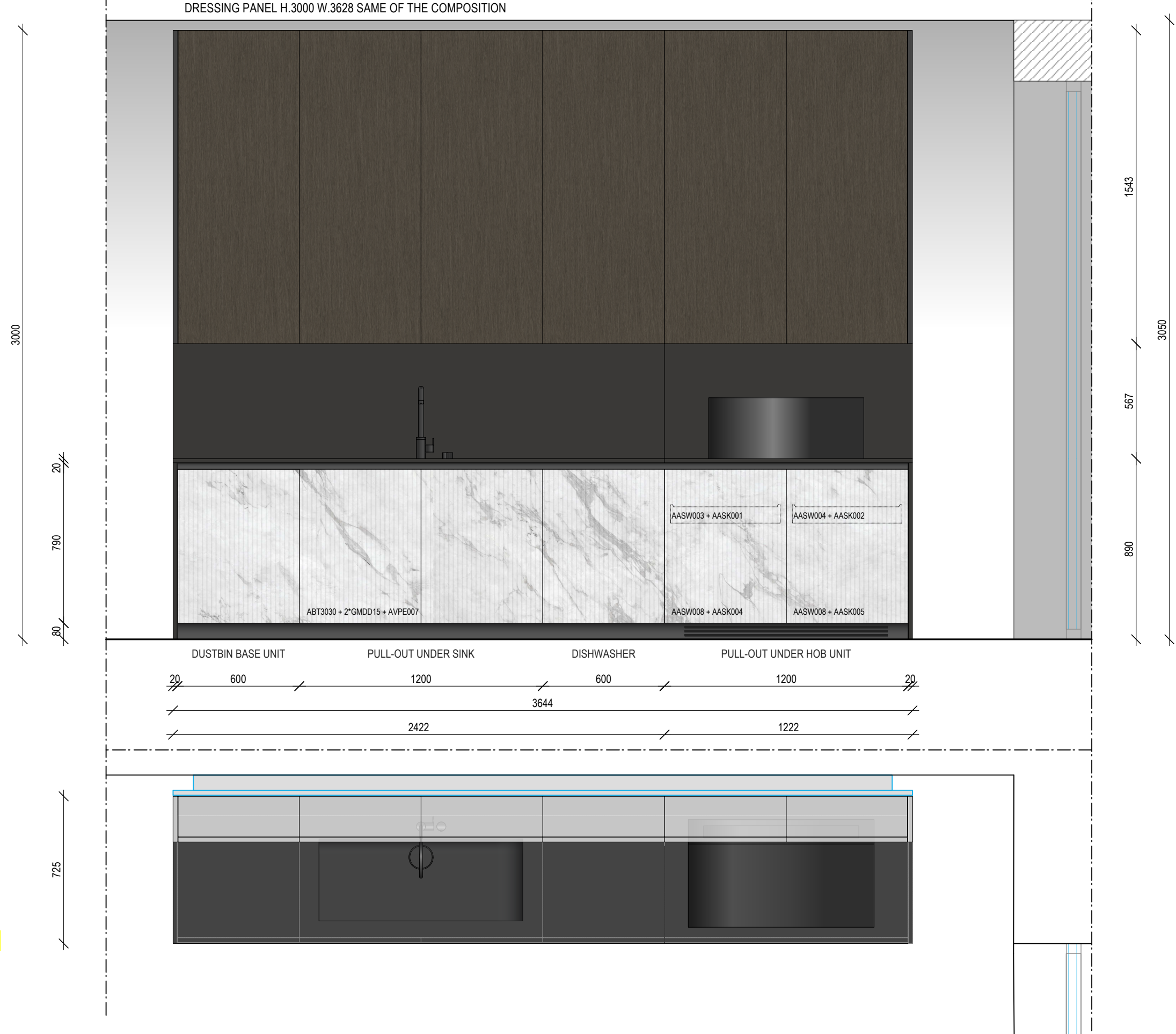

**ATTENZIONE:** profondità piano 725 per presenza cappa

Client BOFFI FRANCE	Location PARIS	Project no. 89-23	Designer CRISTINA BERTAGNIN	Ceiling Height h.3050	Date 25.JULY.2023	Description M30D41-89-23	DRWG 01/01	Scale 1:20	Format A3	Rev. 01
------------------------	-------------------	----------------------	--------------------------------	--------------------------	----------------------	-----------------------------	---------------	---------------	--------------	------------